



WARNING:
CHOKING HAZARD
 Toy contains small parts and functional/sharp points. Not for children under 3 years old. Adult supervision required.



5+

VALENTINE'S TIC-TAC-TOE

Made in Thailand exclusively for The Home Depot by Houseworks, Ltd.
2388 Pleasantdale Road, Atlanta, GA 30340 · 71141 · Thailand 1020

Contents:

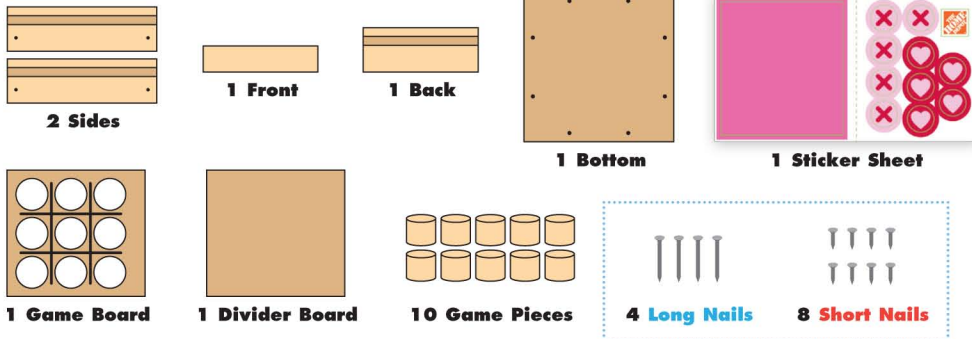

Finished example.

ALSO NEEDED:

- Fine Sandpaper
- Wood Glue
- Hammer

Assembly:

Start with sanding each wood piece to remove any rough edges. Remember to sand in the direction of the wood grain. Glue and nail the pieces together. Allow glue to completely dry.

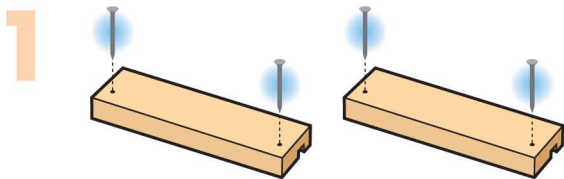

Step 1 — Lay both side pieces down with the slots facing DOWN. Start 4 long nails into the nail holes.

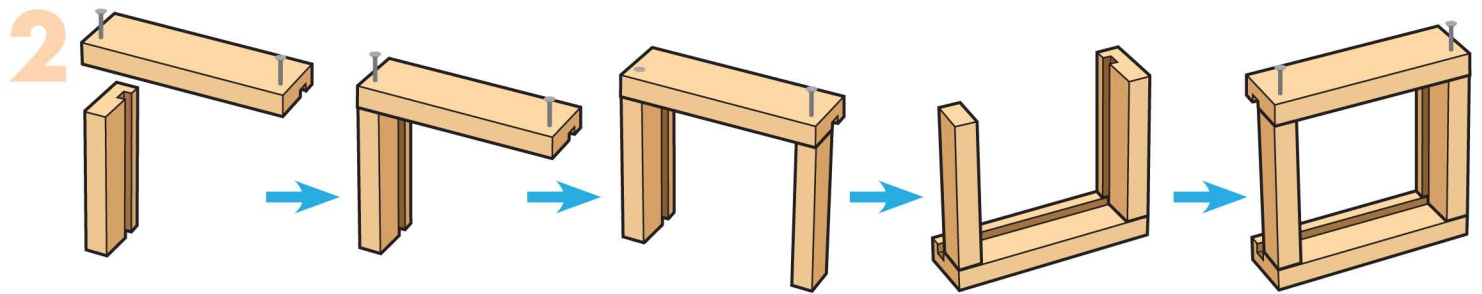

Step 2 — Stand the back piece up. Place one end of the nailed side piece on top. Make sure the slots are matching and edges are even. Nail them together.

Place the front piece under the other started nail. The front piece DOES NOT cover the slot. Make sure edges are even. Nail them together. Turn the project over. Repeat to attach the other side piece.

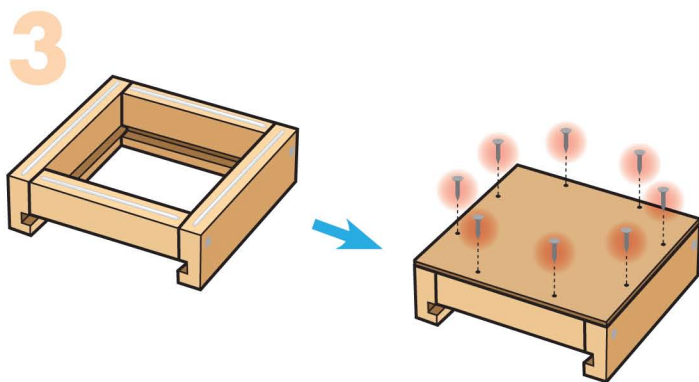

Step 3 — Turn the project upside down. Add thin lines of glue to the top edge. Place the bottom piece on top. Make sure all edges are even. Using 8 short nails, nail it in place.

Attention: If you are painting the project, paint ONLY the game pieces and outside of the box. DO NOT PAINT either boards or slots. Painting the boards and slots will make the boards stick in place!

4

Step 4 — Add the stickers as shown to the game pieces and divider board. Slide both boards into the slots. You can store the game pieces inside the box when you are not playing.



(Ver el dorso para instrucciones en español.)

TSCA TITLE VI Compliant