



WARNING:
CHOKING HAZARD
 Toy contains small parts and functional/sharp points. Not for children under 3 years old. Adult supervision required.



5+

SCHOOL BUS BOOKENDS

Made in Thailand exclusively for The Home Depot by Houseworks, Ltd.
2388 Pleasantdale Road, Atlanta, GA 30340 · 71147 · Thailand 0421

Contents:

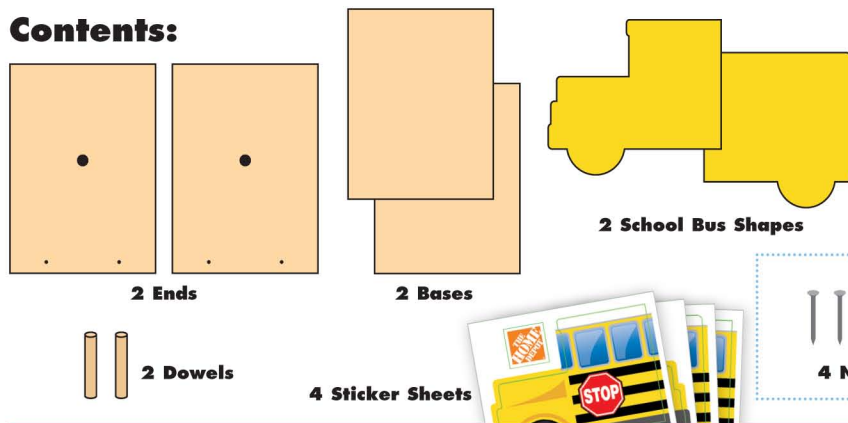

ALSO NEEDED:

- Fine Sandpaper
- Wood Glue
- Hammer

Assembly:

Start with sanding each wood piece to remove any rough edges. Remember to sand in the direction of the wood grain. Glue and nail the pieces together. Allow glue to completely dry.

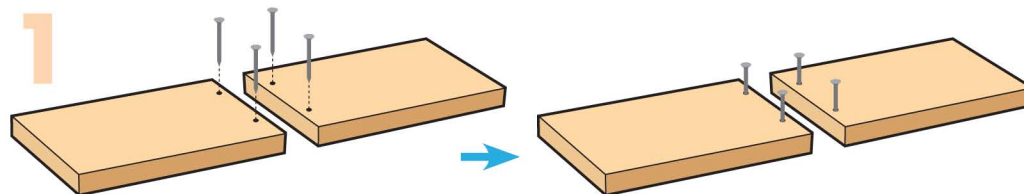

Step 1—Place both end pieces flat with the dowel holes facing down. Start 4 nails.

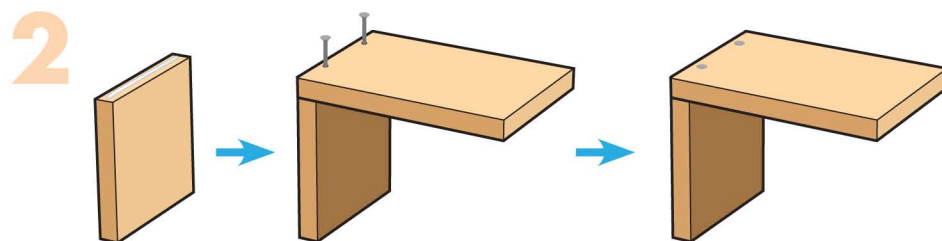

Step 2—Stand one base piece up. Add a line of glue to the top edge. Place one of the end pieces on top. Make sure outside edges are even. Finish nailing. Repeat to attach the other end piece and base piece.

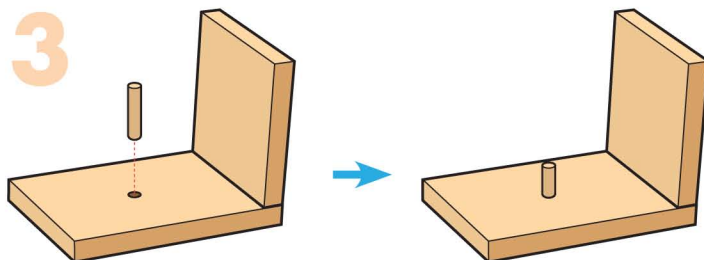

Step 3—Add a tiny dot of glue inside the dowel holes. Push the dowels into the dowel holes.

Attention: If you are painting the project, paint and wait to dry completely before adding the school bus shapes.

4

Step 4—Add the stickers to the school bus shapes. Push the holes in the back of the school bus shapes on the dowels.



(Ver el dorso para instrucciones en español.)