



## WARNING: CHOKING HAZARD

Toy contains small parts and functional/sharp points.  
Not for children under 4 years old.  
Adult supervision required.



# CLASSIC CAR

Made in Chonburi, Thailand exclusively for The Home Depot by Houseworks, Ltd  
2388 Pleasantdale Road, Atlanta, GA 30340 • batch #171108 • date: 02/18

## Contents:

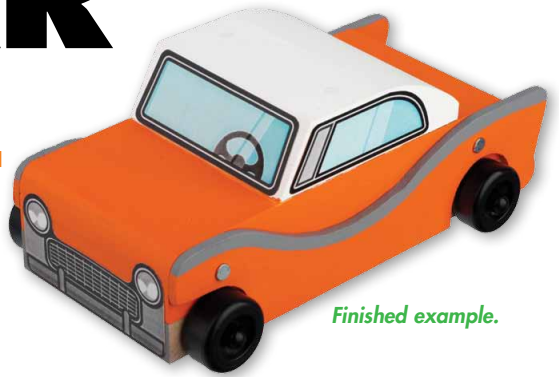
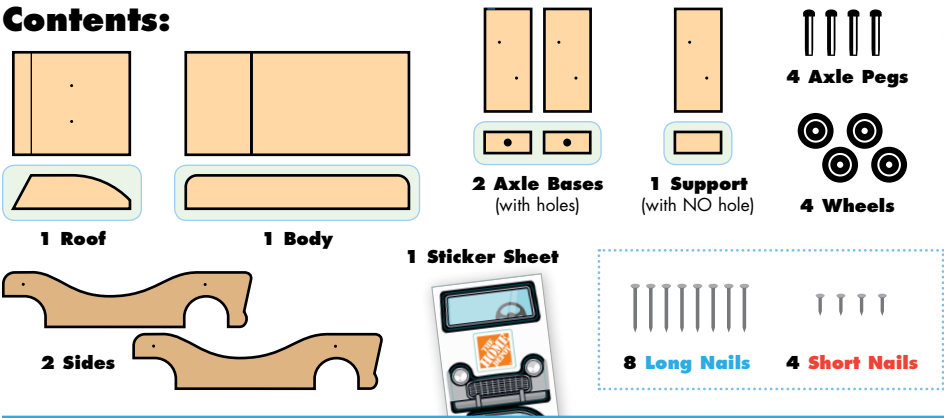

Finished example.

## ALSO NEEDED:

- Safety Goggles
- Fine Sandpaper
- Wood Glue
- Hammer

## Assembly:

Start with sanding each wood piece to remove any rough edges. Remember to sand in the direction of the wood grain. Glue and nail the pieces together. Allow glue to completely dry.

1

Step 1 — Lay both axle base pieces and the support piece flat with the nail holes on top. Start 6 long nails.

2

Step 2 — Lay the body piece upside down with the rounded edges at bottom. Glue one of the axle base pieces (with holes) to one of the short edges. Make sure outside edges are even. Finish nailing. Repeat to glue and nail the other axle base piece (with holes) to the other short edge. Center and glue the support piece (with NO hole) in between the axle base pieces. Make sure side edges are even. Finish nailing.

3

Step 3 — Lay the roof piece flat side down. Start 2 long nails. Turn the project over. Glue the roof piece on top using the line as a guide. Match the line with the front edge of the roof piece. Make sure side edges are even. Finish nailing.

4

Step 4 — Turn the project on one side. Place one of the side pieces on the body piece. Match the front round edges and top edges. The front edge should be even and the back edge should stick out beyond the body piece. Using 2 short nails, nail it in place. Turn the project over and repeat to nail the other side piece.

5

Step 5 — Slide an axle peg through each wheel. Lightly hammer an axle peg and wheel into each of the 4 axle holes. Apply the stickers as shown.

Hint: If you are painting the project, **DO NOT PAINT inside or around the axle holes.** Painting inside or around the axle holes make it difficult to add wheels. Allow the paint to dry completely.

(Ver el dorso para instrucciones en español.)

California 93120 compliant for formaldehyde phase 2