



WARNING:
CHOKING HAZARD
Contains small parts and functional/sharp points.
Not for children under 3 years old.
Adult supervision required.



5+

TOOL BENCH

Made in Thailand exclusively for The Home Depot by Houseworks, Ltd.
2388 Pleasantdale Road, Atlanta, GA 30340 • 71133 • Thailand 0220

Contents:

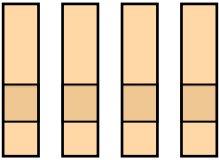

4 Legs

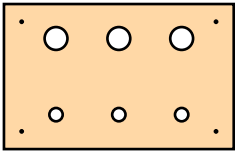

1 Benchtop

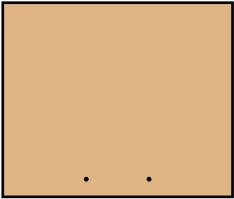

1 Backboard

1 Sticker Sheet

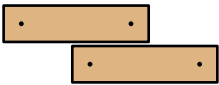

2 Braces



4 Short Nails



2 Medium Nails



4 Long Nails



Finished example.



ALSO NEEDED:

- Fine Sandpaper
- Wood Glue
- Hammer

Assembly:

Start with sanding each wood piece to remove any rough edges. Remember to sand in the direction of the wood grain. Glue and nail the pieces together. Allow glue to completely dry.



Step 1—Identify 4 **short nails**, 2 **medium nails** and 4 **long nails**.

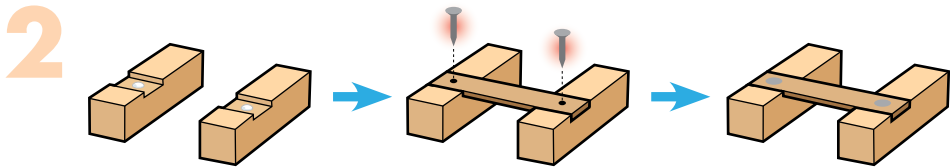

Step 2—Lay 2 **legs** down with the **grooves on top**. Add a tiny dot of glue to each groove. Fit one of the **braces** into the grooves. Make sure side edges are even. Using 2 **short nails**, nail them together. Repeat with the other 2 **legs** and **brace**.

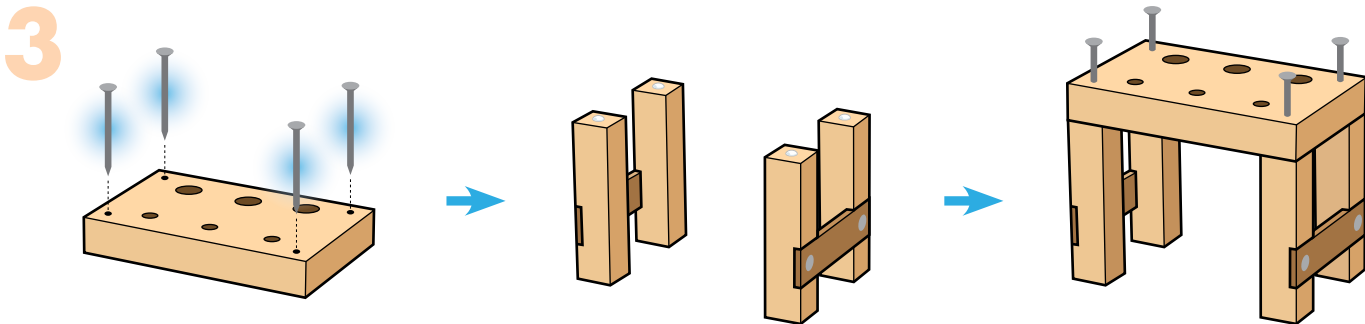

Step 3—Place the **benchtop** flat. Start 4 **long nails** into the nail holes in the corners. Stand both **leg assemblies** up with the **braces facing out and close to the bottom**. Add a tiny dot of glue to the top edge of each **leg**. Place the **benchtop** on top. Make sure all edges are even. Carefully, nail them together.

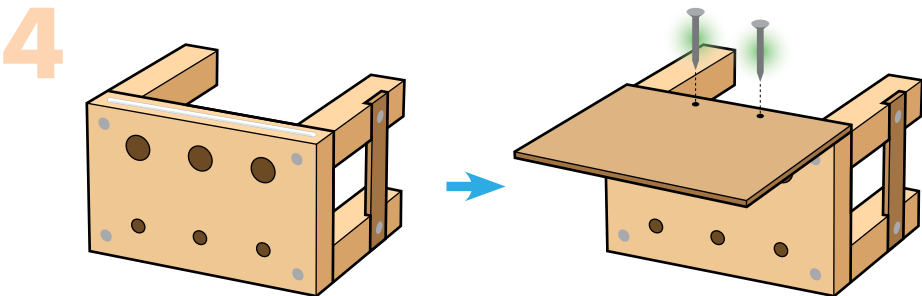

Step 4—Turn the project down with the 3 big holes in the **benchtop** close to the top. Add a thin line of glue to the top edge of the **benchtop**. Place the **backboard** on top. Make sure side and bottom edges are even. Using 2 **medium nails**, nail it in place.

Attention: If you are painting the project, paint and wait to dry completely before adding the **sticker**.

5

Step 5—Add the **sticker** to the **backboard**.

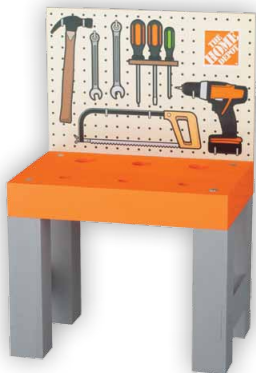

(Ver el dorso para instrucciones en español.)

TSCA TITLE VI Compliant