



WARNING: CHOKING HAZARD

Toy contains small parts and functional/sharp points. Not for children under 4 years old.
Adult supervision required.



PENSKE TRUCK

Made in Chonburi, Thailand exclusively for The Home Depot by Houseworks, Ltd
2388 Pleasantdale Road, Atlanta, GA 30340 • batch #171097 • date: 04/17

Contents:

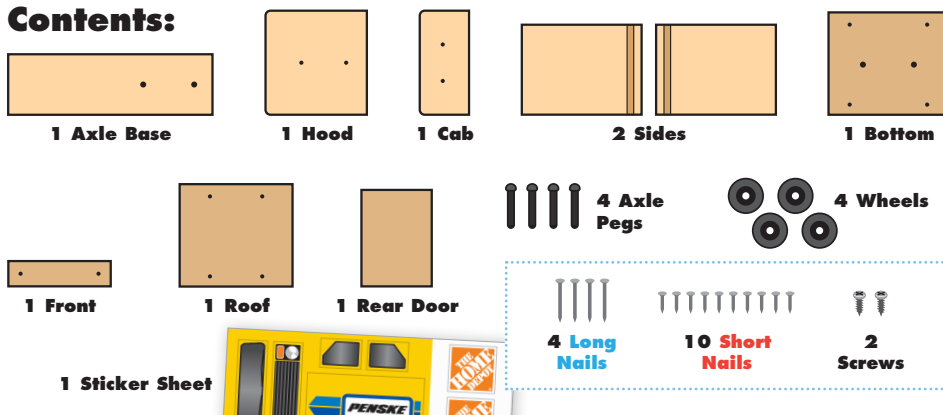

Finished example.

ALSO NEEDED:

- Safety Goggles
- Fine Sandpaper
- Wood Glue
- Hammer
- Phillips Head Screwdriver

Assembly:

Start with sanding each wood piece to remove any rough edges. Remember to sand in the direction of the wood grain. Glue and nail the pieces together. Allow glue to completely dry.

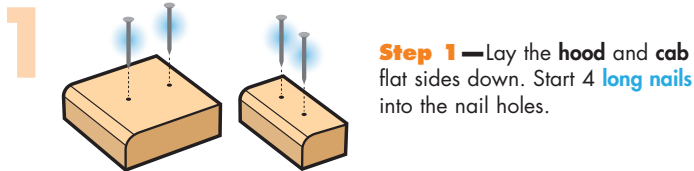

Step 1 — Lay the hood and cab flat sides down. Start 4 long nails into the nail holes.

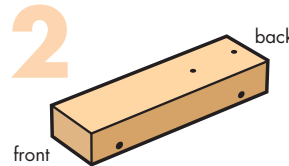

Step 2 — Lay the axle base down with the screw holes on top and axle holes close to the bottom.

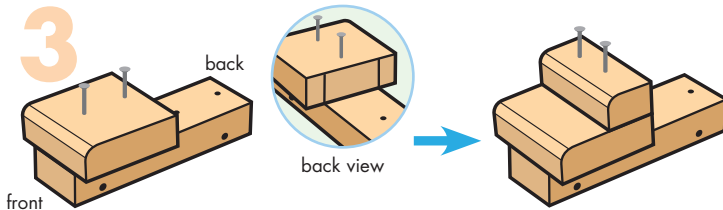

Step 3 — Center and glue the hood over the axle base with the rounded end even with the front edge (**DO NOT cover the screw holes**). Use the 2 lines on the back of the hood to line up with the axle base. Nail them together.

Glue the cab onto the hood with the side and back edges even. Nail them together.

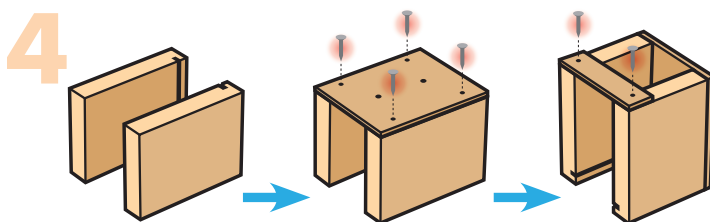

Step 4 — Stand the 2 side pieces up onto the long edges with the slots facing each other. Glue the bottom piece on the side pieces with all edges even. Using 4 short nails, nail them together through the nail holes.

Turn it up onto the slot end. Glue the front piece to the side pieces on the open end. Make sure edges are even. Using 2 short nails, nail them together through the nail holes.

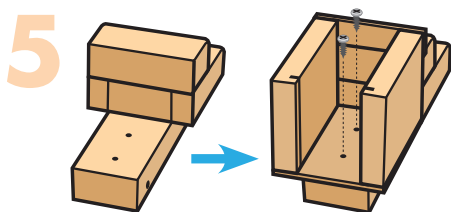

Step 5 — Glue the bottom piece over the axle base with the side edges even. Make sure the slots are at the back. Using 2 screws, attach the bottom piece to the axle base through the screw holes.

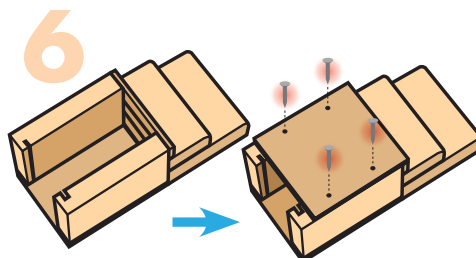

Step 6 — Place the roof over the front and side pieces (**DON'T cover the slots**). Using 4 short nails, nail them together through the nail holes.

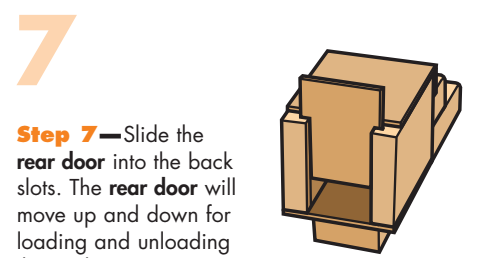

Step 7 — Slide the rear door into the back slots. The rear door will move up and down for loading and unloading the truck.

Push an axle peg through each wheel. Hammer an axle peg and wheel into each of the 4 axle holes.



Attention: If you are painting the truck, **DO NOT PAINT** either rear door or slots. Painting the rear door and slots will make the rear door stick in place. Allow the paint to dry completely. Apply the stickers as shown above.

(Ver el dorso para instrucciones en español.)

California 93120 compliant for formaldehyde phase 2